

WZ7092 - Букса тип В

Стр.1 от 4

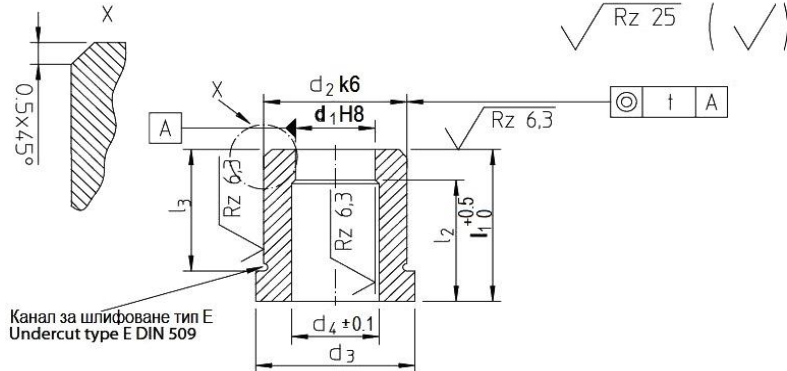

DIN 9845 тип В

Материал / Mat: HWS 12%Cr

Твърдост / Hardness: 62+/-2 HRC

Други материали, твърдост или стъпка до 0.01 мм са възможни по запитване. /

Other dimensions, materials and step 0.01 mm available on request.

Офис Централен:

ж.к. Люлин-Център, ул. Архитект
 Георги Ненов №31
 1324 София, България
 тел: +359 (2) 923 44 88
 тел: +359 884 612 894
 факс: +359 (2) 923 44 55

Офис Пловдив:

Електроапаратурен завод –
 ЕАЗ АД, Бул. Цар Борис III
 Обединител, №1-продължение,
 ет.3, офис 48
 4000 Пловдив, България
 тел: +359 888 055 215
 тел: +359 884 605 128
office@krasco.com
www.krasco.com

Код DxL	d1	l1	l2	l3	Step	d2	d3	d4	t
WZ7092/01,0x20	1	20	18	16	0.1	5	7	0.3	0.01
WZ7092/01,2x20	1.2	20	18	16	0.1	5	7	0.3	0.01
WZ7092/01,2x28	1.2	28	26	24	0.1	5	7	0.3	0.01
WZ7092/01,3x20	1.3	20	18	16	0.1	5	7	0.3	0.01
WZ7092/01,3x28	1.3	28	26	24	0.1	5	7	0.3	0.01
WZ7092/01,4x20	1.4	20	18	16	0.1	5	7	0.3	0.01
WZ7092/01,4x28	1.4	28	26	24	0.1	5	7	0.3	0.01
WZ7092/01,5x20	1.5	20	18	16	0.1	5	7	0.3	0.01
WZ7092/01,5x28	1.5	28	26	24	0.1	5	7	0.3	0.01
WZ7092/01,6x20	1.6	20	18	16	0.1	5	7	0.3	0.01
WZ7092/01,6x28	1.6	28	26	24	0.1	5	7	0.3	0.01
WZ7092/01,7x20	1.7	20	18	16	0.1	5	7	0.3	0.01
WZ7092/01,7x28	1.7	28	26	24	0.1	5	7	0.3	0.01
WZ7092/01,8x20	1.8	20	18	16	0.1	5	7	0.3	0.01
WZ7092/01,8x28	1.8	28	26	24	0.1	5	7	0.3	0.01
WZ7092/01,9x20	1.9	20	18	16	0.1	5	7	0.3	0.01
WZ7092/01,9x28	1.9	28	26	24	0.1	5	7	0.3	0.01
WZ7092/02,0x20	2	20	17	16	0.1	6	8	0.3	0.01
WZ7092/02,0x28	2	28	25	24	0.1	6	8	0.3	0.01
WZ7092/02,1x20	2.1	20	17	16	0.1	7	9	0.5	0.01
WZ7092/02,1x28	2.1	28	25	24	0.1	7	9	0.5	0.01
WZ7092/02,2x20	2.2	20	17	16	0.1	7	9	0.5	0.01
WZ7092/02,2x28	2.2	28	25	24	0.1	7	9	0.5	0.01
WZ7092/02,3x20	2.3	20	17	16	0.1	7	9	0.5	0.01
WZ7092/02,3x28	2.3	28	25	24	0.1	7	9	0.5	0.01
WZ7092/02,4x20	2.4	20	17	16	0.1	7	9	0.5	0.01
WZ7092/02,4x28	2.4	28	25	24	0.1	7	9	0.5	0.01
WZ7092/02,5x20	2.5	20	17	16	0.1	7	9	0.5	0.01
WZ7092/02,5x28	2.5	28	25	24	0.1	7	9	0.5	0.01
WZ7092/02,6x20	2.6	20	17	16	0.1	7	9	0.5	0.01
WZ7092/02,6x28	2.6	28	25	24	0.1	7	9	0.5	0.01
WZ7092/02,7x20	2.7	20	17	16	0.1	7	9	0.5	0.01
WZ7092/02,7x28	2.7	28	25	24	0.1	7	9	0.5	0.01
WZ7092/02,8x20	2.8	20	17	16	0.1	7	9	0.5	0.01
WZ7092/02,8x28	2.8	28	25	24	0.1	7	9	0.5	0.01
WZ7092/02,9x20	2.9	20	17	16	0.1	7	9	0.5	0.01

Код DxL	d1	l1	l2	l3	Step	d2	d3	d4	t
WZ7092/02,9x28	2.9	28	25	24	0.1	7	9	0.5	0.01
WZ7092/03,0x20	3	20	17	16	0.1	7	9	0.5	0.01
WZ7092/03,0x28	3	28	25	24	0.1	7	9	0.5	0.01
WZ7092/03,1x20	3.1	20	17	16	0.1	8	10	0.5	0.01
WZ7092/03,1x28	3.1	28	25	24	0.1	8	10	0.5	0.01
WZ7092/03,2x20	3.2	20	17	16	0.1	8	10	0.5	0.01
WZ7092/03,2x28	3.2	28	25	24	0.1	8	10	0.5	0.01
WZ7092/03,3x20	3.3	20	17	16	0.1	8	10	0.5	0.01
WZ7092/03,3x28	3.3	28	25	24	0.1	8	10	0.5	0.01
WZ7092/03,4x20	3.4	20	17	16	0.1	8	10	0.5	0.01
WZ7092/03,4x28	3.4	28	25	24	0.1	8	10	0.5	0.01
WZ7092/03,5x20	3.5	20	17	16	0.1	8	10	0.5	0.01
WZ7092/03,5x28	3.5	28	25	24	0.1	8	10	0.5	0.01
WZ7092/03,6x20	3.6	20	17	16	0.1	8	10	0.5	0.01
WZ7092/03,6x28	3.6	28	25	24	0.1	8	10	0.5	0.01
WZ7092/03,7x20	3.7	20	17	16	0.1	8	10	0.5	0.01
WZ7092/03,7x28	3.7	28	25	24	0.1	8	10	0.5	0.01
WZ7092/03,8x20	3.8	20	17	16	0.1	8	10	0.5	0.01
WZ7092/03,8x28	3.8	28	17	24	0.1	8	10	0.5	0.01
WZ7092/03,9x20	3.9	20	17	16	0.1	8	10	0.5	0.01
WZ7092/03,9x28	3.9	28	25	24	0.1	8	10	0.5	0.01
WZ7092/04,0x20	4	20	17	16	0.1	8	10	0.5	0.01
WZ7092/04,0x28	4	28	25	24	0.1	8	10	0.5	0.01
WZ7092/04,1x20	4.1	20	16	16	0.1	10	12	0.7	0.01
WZ7092/04,1x28	4.1	28	24	24	0.1	10	12	0.7	0.01
WZ7092/04,2x20	4.2	20	16	16	0.1	10	12	0.7	0.01
WZ7092/04,2x28	4.2	28	24	24	0.1	10	12	0.7	0.01
WZ7092/04,3x20	4.3	20	16	16	0.1	10	12	0.7	0.01
WZ7092/04,3x28	4.3	28	24	24	0.1	10	12	0.7	0.01
WZ7092/04,4x20	4.4	20	16	16	0.1	10	12	0.7	0.01
WZ7092/04,4x28	4.4	28	24	24	0.1	10	12	0.7	0.01
WZ7092/04,5x20	4.5	20	16	16	0.1	10	12	0.7	0.01
WZ7092/04,5x28	4.5	28	24	24	0.1	10	12	0.7	0.01
WZ7092/04,6x20	4.6	20	16	16	0.1	10	12	0.7	0.01
WZ7092/04,6x28	4.6	28	24	24	0.1	10	12	0.7	0.01
WZ7092/04,7x20	4.7	20	16	16	0.1	10	12	0.7	0.01

WZ7092 - Букса тип В

Стр.2 от 4

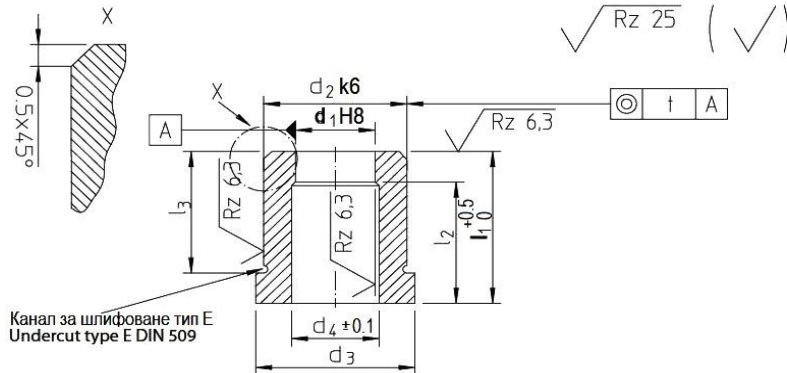

DIN 9845 тип В

Материал / Mat: HWS 12%Cr

Твърдост / Hardness: 62+/-2 HRC

Други материали, твърдост или стъпка до 0.01 мм са възможни по запитване. /

Other dimensions, materials and step 0.01 mm available on request.

Офис Централен:

ж.к. Люлин-Център, ул. Архитект
 Георги Ненов №31
 1324 София, България
 тел: +359 (2) 923 44 88
 тел: +359 884 612 894
 факс: +359 (2) 923 44 55

Офис Пловдив:

Електроапаратурен завод –
 ЕАЗ АД, Бул. Цар Борис III
 Обединител, №1-продължение,
 ет.3, офис 48
 4000 Пловдив, България
 тел: +359 888 055 215
 тел: +359 884 605 128
office@krasco.com
www.krasco.com

Код DxL	d1	l1	l2	l3	Step	d2	d3	d4	t
WZ7092/04,7x28	4.7	28	24	24	0.1	10	12	0.7	0.01
WZ7092/04,8x20	4.8	20	16	16	0.1	10	12	0.7	0.01
WZ7092/04,8x28	4.8	28	24	24	0.1	10	12	0.7	0.01
WZ7092/04,9x20	4.9	20	16	16	0.1	10	12	0.7	0.01
WZ7092/04,9x28	4.9	28	24	24	0.1	10	12	0.7	0.01
WZ7092/05,0x20	5	20	16	16	0.1	10	12	0.7	0.01
WZ7092/05,0x28	5	28	24	24	0.1	10	12	0.7	0.01
WZ7092/05,1x20	5.1	20	16	16	0.1	12	14	0.7	0.02
WZ7092/05,2x20	5.2	20	16	16	0.1	12	14	0.7	0.02
WZ7092/05,2x28	5.2	28	24	24	0.1	12	14	0.7	0.02
WZ7092/05,3x20	5.3	20	16	16	0.1	12	14	0.7	0.02
WZ7092/05,3x28	5.3	28	24	24	0.1	12	14	0.7	0.02
WZ7092/05,4x20	5.4	20	16	16	0.1	12	14	0.7	0.02
WZ7092/05,4x28	5.4	28	24	24	0.1	12	14	0.7	0.02
WZ7092/05,5x20	5.5	20	16	16	0.1	12	14	0.7	0.02
WZ7092/05,5x28	5.5	28	24	24	0.1	12	14	0.7	0.02
WZ7092/05,6x20	5.6	20	16	16	0.1	12	14	0.7	0.02
WZ7092/05,6x28	5.6	28	24	24	0.1	12	14	0.7	0.02
WZ7092/05,7x20	5.7	20	16	16	0.1	12	14	0.7	0.02
WZ7092/05,7x28	5.7	28	24	24	0.1	12	14	0.7	0.02
WZ7092/05,8x20	5.8	20	16	16	0.1	12	14	0.7	0.02
WZ7092/05,8x28	5.8	28	24	24	0.1	12	14	0.7	0.02
WZ7092/05,9x20	5.9	20	16	16	0.1	12	14	0.7	0.02
WZ7092/05,9x28	5.9	28	24	24	0.1	12	14	0.7	0.02
WZ7092/06,0x20	6	20	16	16	0.1	12	14	0.7	0.02
WZ7092/06,0x28	6	28	24	24	0.1	12	14	0.7	0.02
WZ7092/06,1x20	6.1	20	16	16	0.1	15	17	0.7	0.02
WZ7092/06,1x28	6.1	28	24	24	0.1	15	17	0.7	0.02
WZ7092/06,2x20	6.2	20	16	16	0.1	15	17	0.7	0.02
WZ7092/06,2x28	6.2	28	24	24	0.1	15	17	0.7	0.02
WZ7092/06,3x20	6.3	20	16	16	0.1	15	17	0.7	0.02
WZ7092/06,3x28	6.3	28	24	24	0.1	15	17	0.7	0.02
WZ7092/06,4x20	6.4	20	16	16	0.1	15	17	0.7	0.02
WZ7092/06,4x28	6.4	28	24	24	0.1	15	17	0.7	0.02
WZ7092/06,5x20	6.5	20	16	16	0.1	15	17	0.7	0.02
WZ7092/06,5x28	6.5	28	24	24	0.1	15	17	0.7	0.02

Код DxL	d1	l1	l2	l3	Step	d2	d3	d4	t
WZ7092/06,6x20	6.6	20	16	16	0.1	15	17	0.7	0.02
WZ7092/06,6x28	6.6	28	24	24	0.1	15	17	0.7	0.02
WZ7092/06,7x20	6.7	20	16	16	0.1	15	17	0.7	0.02
WZ7092/06,7x28	6.7	28	24	24	0.1	15	17	0.7	0.02
WZ7092/06,8x20	6.8	20	16	16	0.1	15	17	0.7	0.02
WZ7092/06,8x28	6.8	28	24	24	0.1	15	17	0.7	0.02
WZ7092/06,9x20	6.9	20	16	16	0.1	15	17	0.7	0.02
WZ7092/06,9x28	6.9	28	24	24	0.1	15	17	0.7	0.02
WZ7092/07,0x20	7	20	16	16	0.1	15	17	0.7	0.02
WZ7092/07,0x28	7	28	24	24	0.1	15	17	0.7	0.02
WZ7092/07,1x20	7.1	20	16	16	0.1	15	17	0.7	0.02
WZ7092/07,1x28	7.1	28	24	24	0.1	15	17	0.7	0.02
WZ7092/07,2x20	7.2	20	16	16	0.1	15	17	0.7	0.02
WZ7092/07,2x28	7.2	28	24	24	0.1	15	17	0.7	0.02
WZ7092/07,3x20	7.3	20	16	16	0.1	15	17	0.7	0.02
WZ7092/07,3x28	7.3	28	24	24	0.1	15	17	0.7	0.02
WZ7092/07,4x20	7.4	20	16	16	0.1	15	17	0.7	0.02
WZ7092/07,4x28	7.4	28	24	24	0.1	15	17	0.7	0.02
WZ7092/07,5x20	7.5	20	16	16	0.1	15	17	0.7	0.02
WZ7092/07,5x28	7.5	28	24	24	0.1	15	17	0.7	0.02
WZ7092/07,6x20	7.6	20	16	16	0.1	15	17	0.7	0.02
WZ7092/07,6x28	7.6	28	24	24	0.1	15	17	0.7	0.02
WZ7092/07,7x20	7.7	20	16	16	0.1	15	17	0.7	0.02
WZ7092/07,7x28	7.7	28	24	24	0.1	15	17	0.7	0.02
WZ7092/07,8x20	7.8	20	16	16	0.1	15	17	0.7	0.02
WZ7092/07,8x28	7.8	28	24	24	0.1	15	17	0.7	0.02
WZ7092/07,9x20	7.9	20	16	16	0.1	15	17	0.7	0.02
WZ7092/07,9x28	7.9	28	24	24	0.1	15	17	0.7	0.02
WZ7092/08,0x20	8	20	16	16	0.1	15	17	0.7	0.02
WZ7092/08,0x28	8	28	24	24	0.1	15	17	0.7	0.02
WZ7092/08,1x20	8.1	20	16	16	0.1	18	20	1	0.02
WZ7092/08,1x28	8.1	28	24	24	0.1	18	20	1	0.02
WZ7092/08,2x20	8.2	20	16	16	0.1	18	20	1	0.02
WZ7092/08,2x28	8.2	28	24	24	0.1	18	20	1	0.02
WZ7092/08,3x20	8.3	20	16	16	0.1	18	20	1	0.02
WZ7092/08,3x28	8.3	28	24	24	0.1	18	20	1	0.02

WZ7092 - Букса тип В

Стр.3 от 4

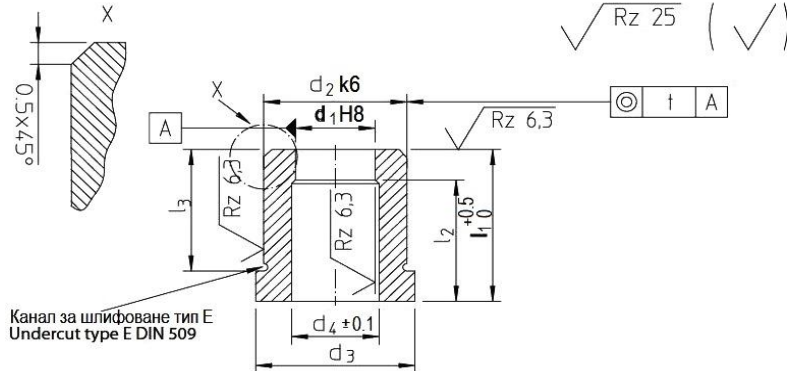

DIN 9845 тип В

Материал / Mat: HWS 12%Cr

Твърдост / Hardness: 62+/-2 HRC

Други материали, твърдост или стъпка до 0.01 мм са възможни по запитване. /

Other dimensions, materials and step 0.01 mm available on request.

Офис Централен:

ж.к. Люлин-Център, ул. Архитект
 Георги Ненов №31
 1324 София, България
 тел: +359 (2) 923 44 88
 тел: +359 884 612 894
 факс: +359 (2) 923 44 55

Офис Пловдив:

Електроапаратурен завод –
 ЕАЗ АД, Бул. Цар Борис III
 Обединител, №1-продължение,
 ет.3, офис 48
 4000 Пловдив, България
 тел: +359 888 055 215
 тел: +359 884 605 128
office@krasco.com
www.krasco.com

Код DxL	d1	l1	l2	l3	Step	d2	d3	d4	t
WZ7092/08,4x20	8.4	20	16	16	0.1	18	20	1	0.02
WZ7092/08,4x28	8.4	28	24	24	0.1	18	20	1	0.02
WZ7092/08,5x20	8.5	20	16	16	0.1	18	20	1	0.02
WZ7092/08,5x28	8.5	28	24	24	0.1	18	20	1	0.02
WZ7092/08,6x20	8.6	20	16	16	0.1	18	20	1	0.02
WZ7092/08,6x28	8.6	28	24	24	0.1	18	20	1	0.02
WZ7092/08,7x20	8.7	20	16	16	0.1	18	20	1	0.02
WZ7092/08,7x28	8.7	28	24	24	0.1	18	20	1	0.02
WZ7092/08,8x20	8.8	20	16	16	0.1	18	20	1	0.02
WZ7092/08,8x28	8.8	28	24	24	0.1	18	20	1	0.02
WZ7092/08,9x20	8.9	20	16	16	0.1	18	20	1	0.02
WZ7092/08,9x28	8.9	28	24	24	0.1	18	20	1	0.02
WZ7092/09,0x20	9	20	16	16	0.1	18	20	1	0.02
WZ7092/09,0x28	9	28	24	24	0.1	18	20	1	0.02
WZ7092/09,1x20	9.1	20	16	16	0.1	18	20	1	0.02
WZ7092/09,1x28	9.1	28	24	24	0.1	18	20	1	0.02
WZ7092/09,2x20	9.2	20	16	16	0.1	18	20	1	0.02
WZ7092/09,2x28	9.2	28	24	24	0.1	18	20	1	0.02
WZ7092/09,3x20	9.3	20	16	16	0.1	18	20	1	0.02
WZ7092/09,3x28	9.3	28	24	24	0.1	18	20	1	0.02
WZ7092/09,4x20	9.4	20	16	16	0.1	18	20	1	0.02
WZ7092/09,4x28	9.4	28	24	24	0.1	18	20	1	0.02
WZ7092/09,5x20	9.5	20	16	16	0.1	18	20	1	0.02
WZ7092/09,5x28	9.5	28	24	24	0.1	18	20	1	0.02
WZ7092/09,6x20	9.6	20	16	16	0.1	18	20	1	0.02
WZ7092/09,6x28	9.6	28	24	24	0.1	18	20	1	0.02
WZ7092/09,7x20	9.7	20	16	16	0.1	18	20	1	0.02
WZ7092/09,7x28	9.7	28	24	24	0.1	18	20	1	0.02
WZ7092/09,8x20	9.8	20	16	16	0.1	18	20	1	0.02
WZ7092/09,8x28	9.8	28	24	24	0.1	18	20	1	0.02
WZ7092/09,9x20	9.9	20	16	16	0.1	18	20	1	0.02
WZ7092/09,9x28	9.9	28	24	24	0.1	18	20	1	0.02
WZ7092/10,0x20	10	20	16	16	0.1	18	20	1	0.02
WZ7092/10,0x28	10	28	24	24	0.1	18	20	1	0.02
WZ7092/10,1x20	10.1	20	16	16	0.1	18	20	1	0.02
WZ7092/10,1x28	10.1	28	24	24	0.1	18	20	1	0.02

Код DxL	d1	l1	l2	l3	Step	d2	d3	d4	t
WZ7092/10,2x20	10.2	20	16	16	0.1	18	20	1	0.02
WZ7092/10,2x28	10.2	28	24	24	0.1	18	20	1	0.02
WZ7092/10,3x20	10.3	20	16	16	0.1	18	20	1	0.02
WZ7092/10,3x28	10.3	28	24	24	0.1	18	20	1	0.02
WZ7092/10,4x20	10.4	20	16	16	0.1	18	20	1	0.02
WZ7092/10,4x28	10.4	28	24	24	0.1	18	20	1	0.02
WZ7092/10,5x20	10.5	20	16	16	0.1	18	20	1	0.02
WZ7092/10,5x28	10.5	28	24	24	0.1	18	20	1	0.02
WZ7092/10,6x20	10.6	20	16	16	0.1	18	20	1	0.02
WZ7092/10,6x28	10.6	28	24	24	0.1	18	20	1	0.02
WZ7092/10,7x20	10.7	20	16	16	0.1	18	20	1	0.02
WZ7092/10,7x28	10.7	28	24	24	0.1	18	20	1	0.02
WZ7092/10,8x20	10.8	20	16	16	0.1	18	20	1	0.02
WZ7092/10,8x28	10.8	28	24	24	0.1	18	20	1	0.02
WZ7092/10,9x20	10.9	20	16	16	0.1	18	20	1	0.02
WZ7092/10,9x28	10.9	28	24	24	0.1	18	20	1	0.02
WZ7092/11,0x20	11	20	15	16	0.1	22	24	1	0.02
WZ7092/11,0x28	11	28	23	24	0.1	22	24	1	0.02
WZ7092/11,1x20	11.1	20	15	16	0.1	22	24	1	0.02
WZ7092/11,1x28	11.1	28	23	24	0.1	22	24	1	0.02
WZ7092/11,2x20	11.2	20	15	16	0.1	22	24	1	0.02
WZ7092/11,2x28	11.2	28	23	24	0.1	22	24	1	0.02
WZ7092/11,3x20	11.3	20	15	16	0.1	22	24	1	0.02
WZ7092/11,3x28	11.3	28	23	24	0.1	22	24	1	0.02
WZ7092/11,4x20	11.4	20	15	16	0.1	22	24	1	0.02
WZ7092/11,4x28	11.4	28	23	24	0.1	22	24	1	0.02
WZ7092/11,5x20	11.5	20	15	16	0.1	22	24	1	0.02
WZ7092/11,5x28	11.5	28	23	24	0.1	22	24	1	0.02
WZ7092/11,6x20	11.6	20	15	16	0.1	22	24	1	0.02
WZ7092/11,6x28	11.6	28	23	24	0.1	22	24	1	0.02
WZ7092/11,7x20	11.7	20	15	16	0.1	22	24	1	0.02
WZ7092/11,7x28	11.7	28	23	24	0.1	22	24	1	0.02
WZ7092/11,8x20	11.8	20	15	16	0.1	22	24	1	0.02
WZ7092/11,8x28	11.8	28	23	24	0.1	22	24	1	0.02
WZ7092/11,9x20	11.9	20	15	16	0.1	22	24	1	0.02
WZ7092/12,0x20	12	20	15	16	0.1	22	24	1	0.02

WZ7092 - Букса тип В

Стр.4 от 4

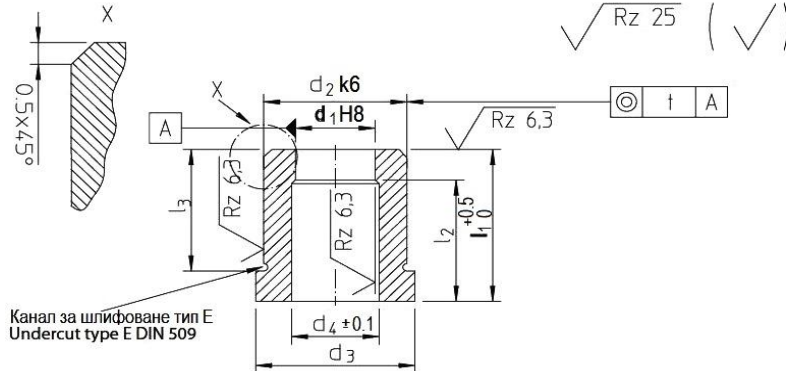

DIN 9845 тип B

Материал / Mat: HWS 12%Cr

Твърдост / Hardness: 62+/-2 HRC

Други материали, твърдост или стъпка до 0.01 мм са възможни по запитване. /

Other dimensions, materials and step 0.01 mm available on request.

Офис Централен:

ж.к. Люлин-Център, ул. Архитект
 Георги Ненов №31
 1324 София, България
 тел: +359 (2) 923 44 88
 тел: +359 884 612 894
 факс: +359 (2) 923 44 55

Офис Пловдив:

Електроапаратурен завод –
 ЕАЗ АД, Бул. Цар Борис III
 Обединител, №1-продължение,
 ет.3, офис 48
 4000 Пловдив, България
 тел: +359 888 055 215
 тел: +359 884 605 128
office@krasco.com
www.krasco.com

Код DxL	d1	l1	l2	l3	Step	d2	d3	d4	t
WZ7092/12,0x28	12	28	23	24	0.1	22	24	1	0.02
WZ7092/12,1x20	12.1	20	15	16	0.1	22	24	1	0.02
WZ7092/12,1x28	12.1	28	23	24	0.1	22	24	1	0.02
WZ7092/12,2x20	12.2	20	15	16	0.1	22	24	1	0.02
WZ7092/12,2x28	12.2	28	23	24	0.1	22	24	1	0.02
WZ7092/12,3x20	12.3	20	15	16	0.1	22	24	1	0.02
WZ7092/12,3x28	12.3	28	23	24	0.1	22	24	1	0.02
WZ7092/12,4x20	12.4	20	15	16	0.1	22	24	1	0.02
WZ7092/12,4x28	12.4	28	23	24	0.1	22	24	1	0.02
WZ7092/12,5x20	12.5	20	15	16	0.1	22	24	1	0.02
WZ7092/12,5x28	12.5	28	23	24	0.1	22	24	1	0.02
WZ7092/12,6x20	12.6	20	15	16	0.1	22	24	1	0.02
WZ7092/12,6x28	12.6	28	23	24	0.1	22	24	1	0.02
WZ7092/12,7x20	12.7	20	15	16	0.1	22	24	1	0.02
WZ7092/12,7x28	12.7	28	23	24	0.1	22	24	1	0.02
WZ7092/12,8x20	12.8	20	15	16	0.1	22	24	1	0.02
WZ7092/12,8x28	12.8	28	23	24	0.1	22	24	1	0.02
WZ7092/12,9x20	12.9	20	15	16	0.1	22	24	1	0.02
WZ7092/13,0x20	13	20	15	16	0.1	26	28	1	0.02
WZ7092/13,0x28	13	28	23	24	0.1	26	28	1	0.02
WZ7092/13,1x20	13.1	20	15	16	0.1	26	28	1	0.02
WZ7092/13,1x28	13.1	28	23	24	0.1	26	28	1	0.02
WZ7092/13,2x20	13.2	20	15	16	0.1	26	28	1	0.02
WZ7092/13,2x28	13.2	28	23	24	0.1	26	28	1	0.02
WZ7092/13,3x20	13.3	20	15	16	0.1	26	28	1	0.02
WZ7092/13,3x28	13.3	28	23	24	0.1	26	28	1	0.02
WZ7092/13,4x20	13.4	20	15	16	0.1	26	28	1	0.02
WZ7092/13,4x28	13.4	28	23	24	0.1	26	28	1	0.02
WZ7092/13,5x20	13.5	20	15	16	0.1	26	28	1	0.02
WZ7092/13,5x28	13.5	28	23	24	0.1	26	28	1	0.02
WZ7092/13,6x20	13.6	20	15	16	0.1	26	28	1	0.02

Код DxL	d1	l1	l2	l3	Step	d2	d3	d4	t
WZ7092/13,6x28	13.6	28	23	24	0.1	26	28	1	0.02
WZ7092/13,8x20	13.8	20	15	16	0.1	26	28	1	0.02
WZ7092/13,8x28	13.8	28	23	24	0.1	26	28	1	0.02
WZ7092/13,9x20	13.9	20	15	16	0.1	26	28	1	0.02
WZ7092/13,9x28	13.9	28	23	24	0.1	26	28	1	0.02
WZ7092/14,0x20	14	20	15	16	0.1	26	28	1	0.02
WZ7092/14,0x28	14	28	23	24	0.1	26	28	1	0.02
WZ7092/14,1x20	14.1	20	15	16	0.1	26	28	1	0.02
WZ7092/14,1x28	14.1	28	23	24	0.1	26	28	1	0.02
WZ7092/14,2x20	14.2	20	15	16	0.1	26	28	1	0.02
WZ7092/14,2x28	14.2	28	23	24	0.1	26	28	1	0.02
WZ7092/14,3x20	14.3	20	15	16	0.1	26	28	1	0.02
WZ7092/14,3x28	14.3	28	23	24	0.1	26	28	1	0.02
WZ7092/14,4x28	14.4	28	23	24	0.1	26	28	1	0.02
WZ7092/14,5x20	14.5	20	15	16	0.1	26	28	1	0.02
WZ7092/14,5x28	14.5	28	23	24	0.1	26	28	1	0.02
WZ7092/14,6x20	14.6	20	15	16	0.1	26	28	1	0.02
WZ7092/14,6x28	14.6	28	23	24	0.1	26	28	1	0.02
WZ7092/14,7x28	14.7	28	23	24	0.1	26	28	1	0.02
WZ7092/14,8x20	14.8	20	15	16	0.1	26	28	1	0.02
WZ7092/14,8x28	14.8	28	23	24	0.1	26	28	1	0.02
WZ7092/14,9x20	14.9	20	15	16	0.1	26	28	1	0.02
WZ7092/14,9x28	14.9	28	23	24	0.1	26	28	1	0.02
WZ7092/15,0x20	15	20	15	16	0.1	26	28	1	0.02
WZ7092/15,0x28	15	28	23	24	0.1	26	28	1	0.02
WZ7092/15,5x28	15.5	28	23	24	0.5	26	32	1	0.02
WZ7092/16,5x28	16	28	23	24	0.5	30	32	1	0.02
WZ7092/17,0x28	17	28	23	24	0.5	30	32	1	0.02
WZ7092/17,5x28	17.5	28	23	24	0.5	30	32	1	0.02
WZ7092/18,0x28	18	28	23	24	0.5	30	32	1	0.02